

- Small switch designed for direct mounting on printed circuit boards
- Low pressure switching
- Slow make contacts
- Available with side tube entry
- Silver contacts
- Switches can be factory set within specified tolerances

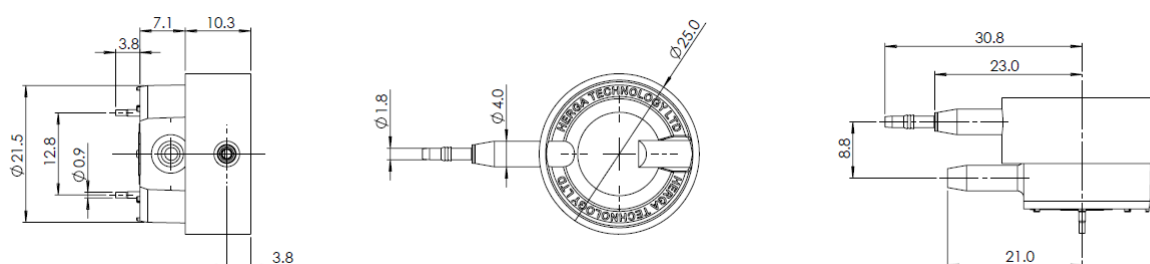

## Reference dimensions in mm



## General specifications

Standards/approvals	n/a	Pressure range	n/a
Degree of protection	n/a	Operating temperature range	-10° C to +85° C (flow solder 220°C for 5 sec)
Connection method	Side entry spout, $\phi 4$ mm with brass reducer fitted (3612-08)	Body material	Thermoplastic
Electrical rating	0.5A 250 V AC	Weight	0.008 kg
Contact configuration	Single pole N/O silver contacts	Additional information	For pressure or vacuum versions see 6763/6761 in Pressure/Vacuum section. Temperature compensated versions available upon request
Diaphragm	Silicone		
Mechanical life	1 x 10 <sup>6</sup> cycles		

## Range options and specifications

Model No.		
Nominal set point	mbar	37
Maximum Hysteresis	mbar	0.15
Body withstand pressure	mbar	2,040
flow rate litre/min (with temperature compensation)	mbar	8 – 30 cc/min @ 77
Pressure connection		side entry spout, $\phi 4$ mm
Connecting tube reference		2311-01 / 2311-08 to suit $\phi 4$ mm spout
Diaphragm		Silicone
Contact plating	Min.	Silver
Contact rating	Min.	10 mA 24V DC
	Max.	0.5 A 250V AC